

# VENDING MACHINE INSTRUCTIONS

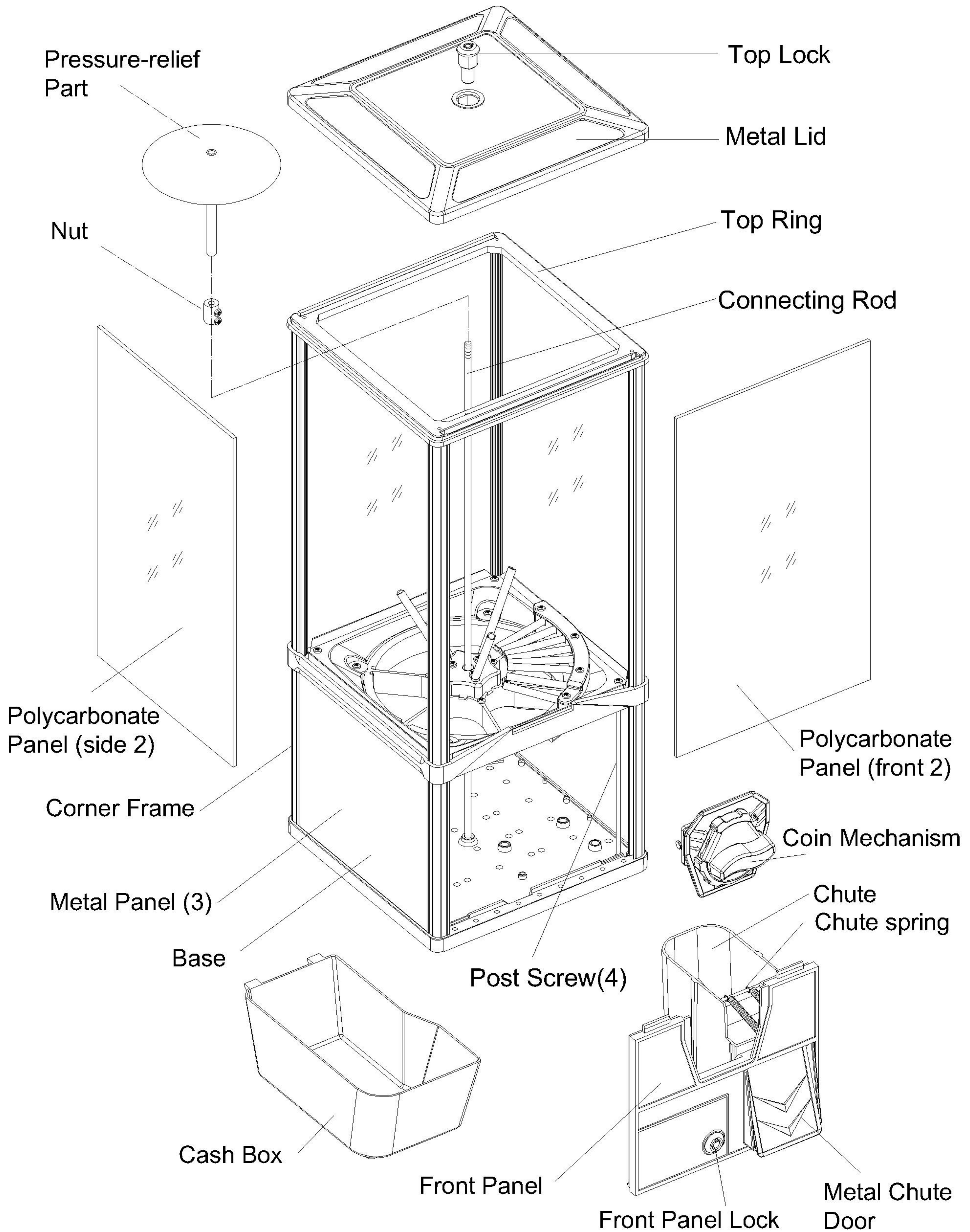

## Initial set-up

1. To change wheels or wheel settings:

A)Unlock and open lid by unscrewing lock.

B)Removing the polycarbonate Panel (Front 2) and Pressure-relief Part removing post screw(4) from the machine (Fig.1)

C)Removing the(6) Adjuster Screw from the gumball wheel.

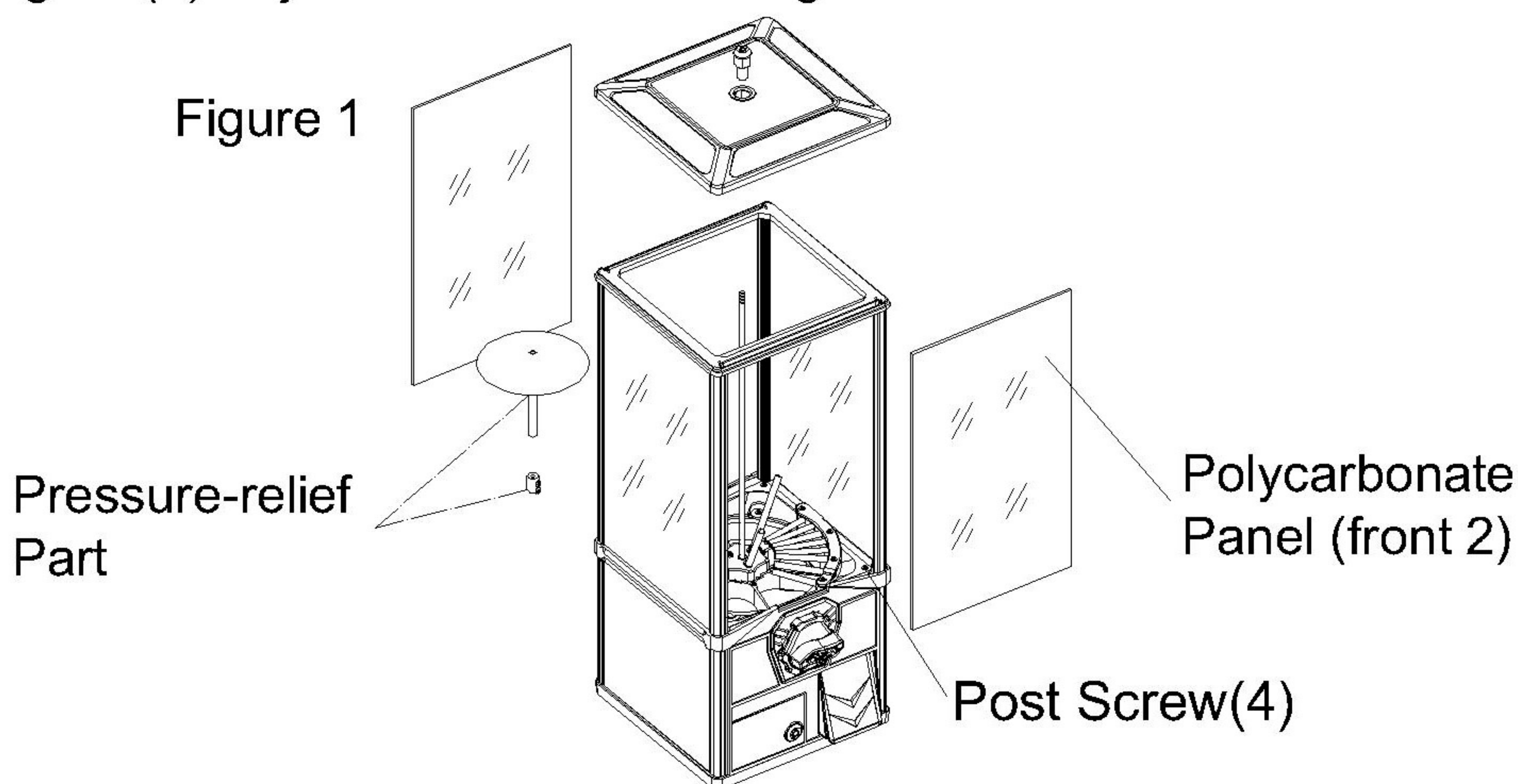

D) For different size gumballs or capsules, you will need to use the 30、 40 or 50、 60mm gumball wheel and brush block settings. The gumball wheel is installed by first installing the risser(Fig.2). The opening of the mark on the gumball must face the front of the vendor. Next, Install gumball wheel so that one of the vending holes is positioned over the opening in the hopper. Next, Install the adjuster block, choose the adjuster block to adjust the opening according to the product being vended. tighten the six(6) adjustment screw. Last, Install the gumball brush spring and adjuster block and brush plate. tighten the four(4) screw. For 30~40mm gumball wheel , brush adjuster block must be placed on top of the Brush spring(Fig3).

When your portion vends at the desired setting. continue filling the vendor with product. Replace the lid and install lock. **NOTE: DO NOT OVERTIGHTEN THE LOCK AS ONLY A SNUG FIT IS NECESSARY.**

Figure 2

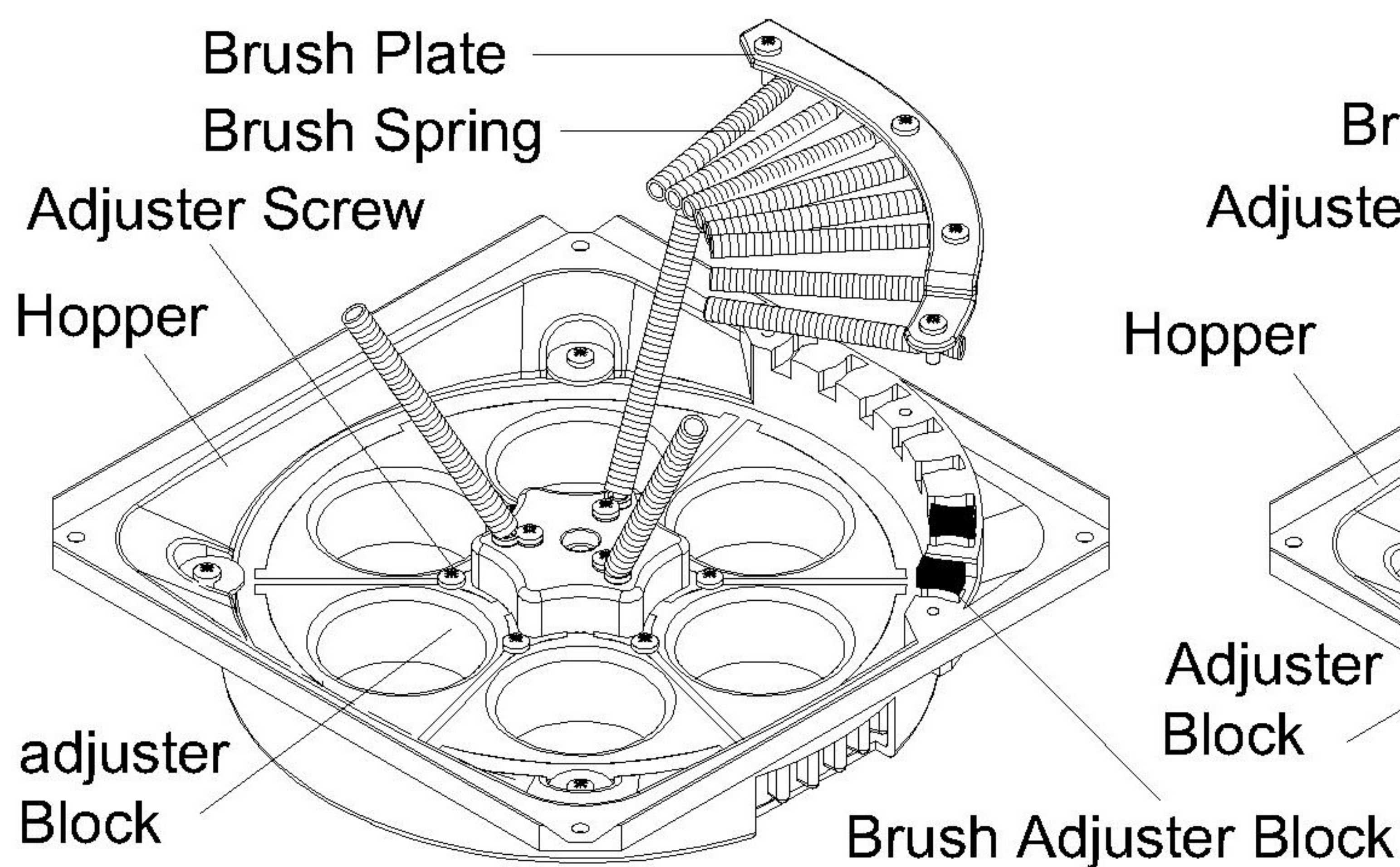
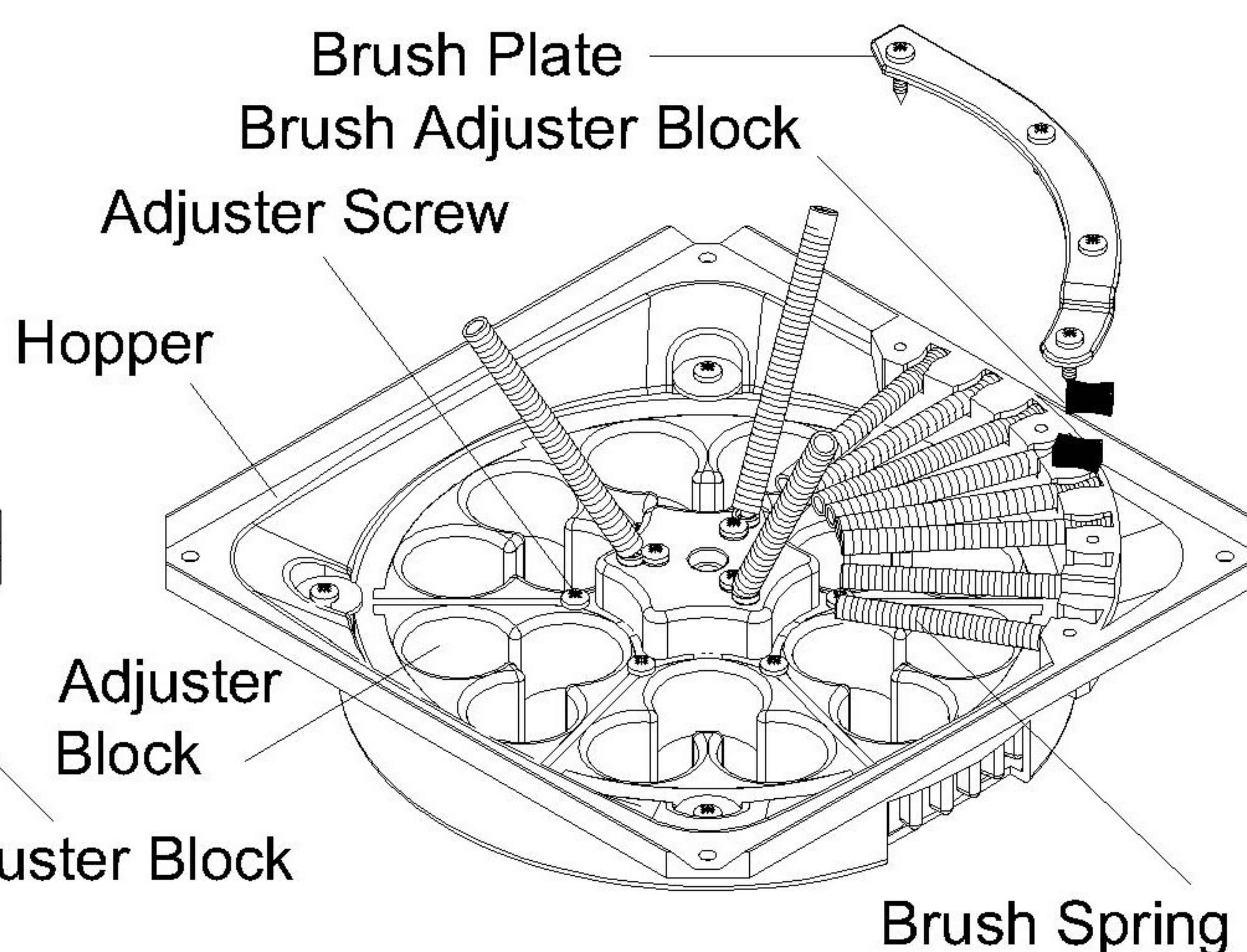

Figure 3



## Coin Mechanism

The coin mechanism (Fig. 4) can be removed by removing the globe lid and lifting off the globe assembly. Once the globe assembly is removed, the coin mechanism can now be lifted upwards and removed.

### 1. To dismantle coin mechanism:

- A) Remove center screw.
- B) Remove sprocket.
- C) Remove three(4) mounting screws.
- D) Pull back plate away from face plate.
- E) Remove jammed coin.
- F) Replace parts in step A-F in reverse order.

Figure 4 coin mechanism Exploded view illustration for adjustment and maintenance only. coin mechanism parts not sold separately.

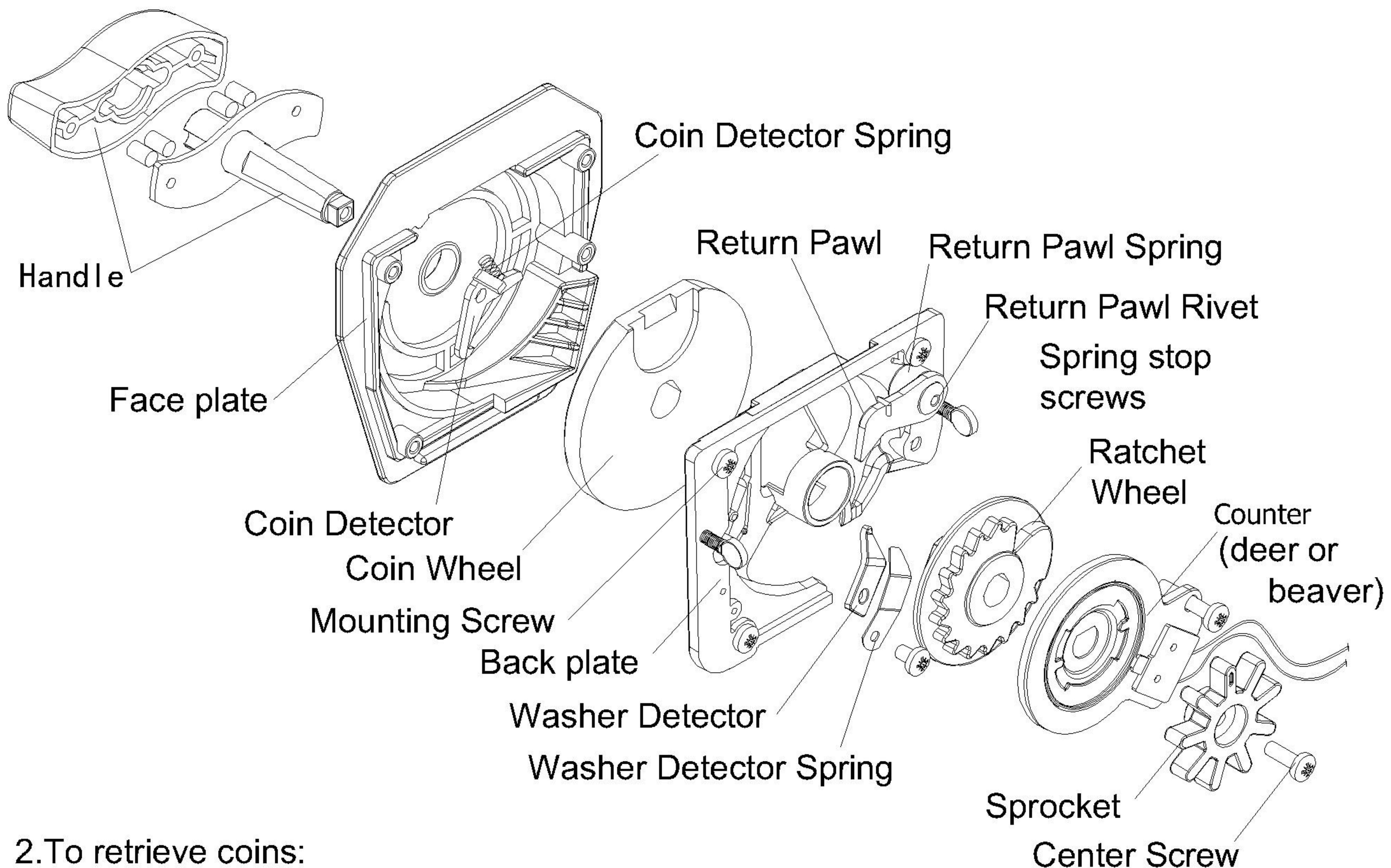

### 2. To retrieve coins:

- A) Unlock and open globe lid by unscrewing lock.
- B) Remove the globe assembly and body assembly.
- C) Retrieve cash.
- D) Replace parts in step A-C in reverse order.

**Note: do not overtighten the lock as only a snug fit is necessary.**

# Heavy Duty Cast Iron Stand

The Heavy Duty Iron Stand itself consists of three(3)main parts.  
The Base threaded Pipe.and threaded Flange.

## 1.For Single Mount:

- A.)Place the threaded pipe into the threaded opening on the Pedestal Base and tighten
- B.)Place the Threaded Flange onto Threded Pipe .Flat side up.
- C.)Secure the Pedestal Base and tighten the Threded Flange by turning Clockwise
- D.)Disassemble vendor to free Base(See: Coin Retrieval)
- E.)Align holes in vendor's Base to the large holes in the Threaded Flange.  
(Fig.5)Note:The front of the Base has a notch for the product Chute.
- F.)Insert two(2)bolts From threaded Flange through Base.
- G.)Apply washers and nuts.Tighten.**DO NOT OVER THIGHTEN.**
- H.)Reassemble vendor .

Figure 5 Heavy Duty Cast Iron Stand Mounting

Single Mount

Double Mount

Base

Base

Threaded Flange

Bracket Tube

Pedestal Tube

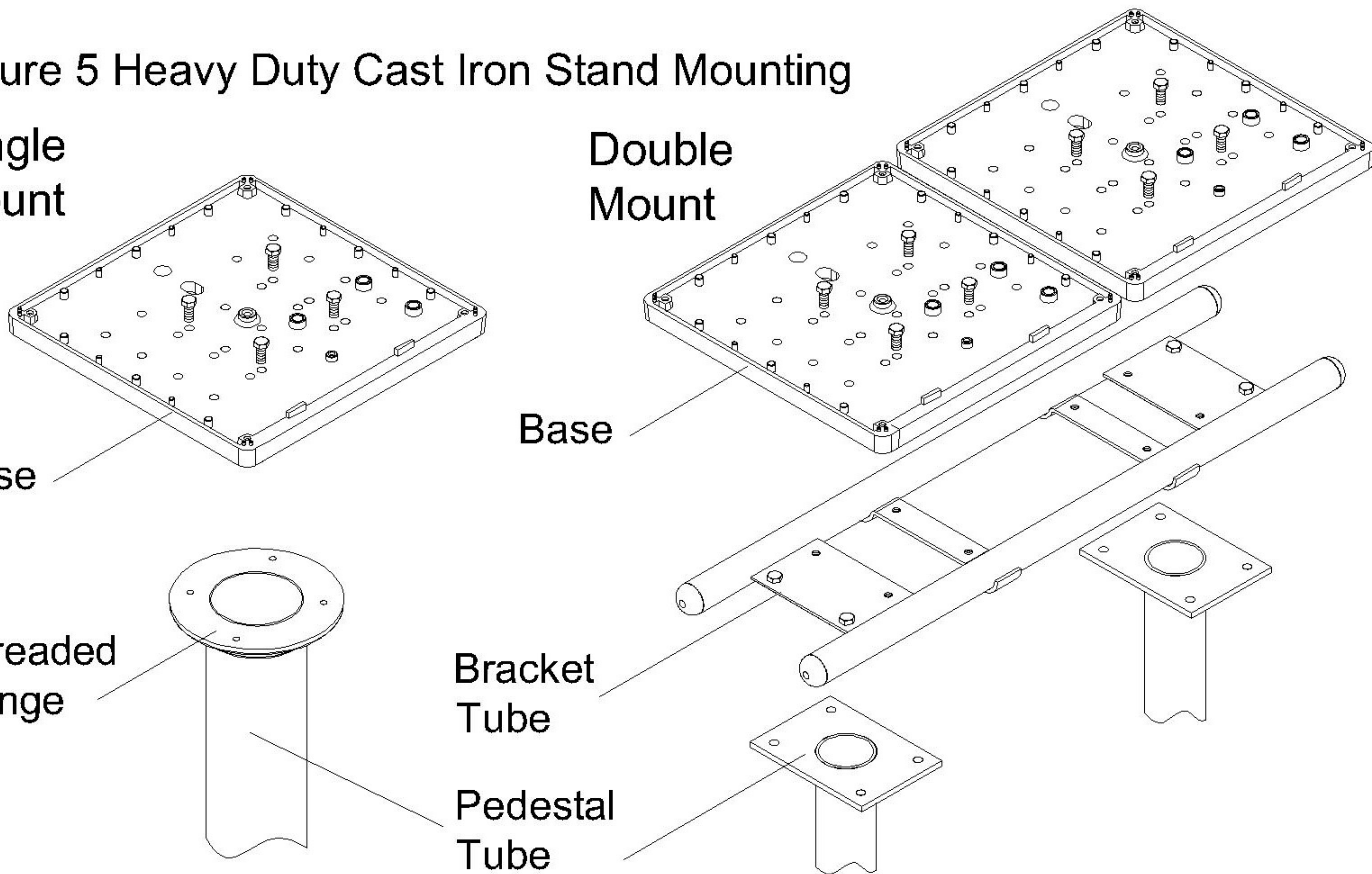

## 2.Remove Instruction & Diagram for Double Mount:

- A.)Complete steps A-D as shown in Single Mount.
- B.)Place Large Double Bracket on top,and align large holes in threaded Flange holes in large Double Bracket.(Fig. 5)
- C.)Insert bolts as shown.(Fig.5)
- D.)Disassemble both Vendors to free Base.(See:Coin Retrieval)
- E.)Align Front an rear most holes in Base to the outer most holes in the Large Double Brackct.(Fig.5)Note:The front of the Base has a notch for in the product Chute
- F.)Insert two(2)bolts(Per vendor)down from the large Double Bracket.
- G.)Apply washers and nuts.Tighten.**DO NOT OVER THIGHTEN-OVER TIGHTENING CAN CRACK THE BASE AND VOID WARRANTY.**
- H.)Reassemble vendors.